

SlimLamp

T5 Linear Illumination



SlimLamp

SlimLamp has a remarkably low profile and comes in five different lengths to make it ideally suitable for any under cabinet installation where an inconspicuous light source is required. Its built-in electronic ballast provides instant-on starting with no flickering, and has a silent operation. It gives off extremely low heat, so it is the perfect lighting for heat-sensitive items. The fixture is easy to install with a snap-in system, capable of combining several fixtures effortlessly.

Easy connection



C-type
Installation
without bracket



Product Features

- Built-in electronic ballast
- Linkable up to 400W together with only one power outlet
- Cool operation ideal for heat-sensitive item display
- Rigid aluminum extruded body and snap-in mounting brackets
- Polycarbonate diffuser that gives a soft glow

Benefits

- Low energy consumption, high light output
- Instant-on starting, no flicker, long lamp life : 20,000hrs,
- Superior strength with aluminum body
- Ballast and lamp shut down if fault present
- Satisfy world class standard, CE & TUV certified and UL listed

Application

- Space for Modern design by using T5 size (16mm)
- Office, Hotel, Living room, Cabinet, Showcase, Furniture

Specification

- Frequency range : 50/60Hz
- Voltage : 220~240V, 110~130V
- Power factor : >97%
- Color rendering : Ra>80
- Tube life: 20,000hr
- Tube diameter: 16mm(T5)
- Class of protection II
- Degree of protection IP20

Installation

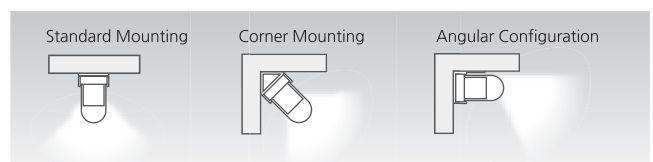



Notice

- Max. connection : 400W
- 8W(50pcs), 14W(28pcs), 21W(19pcs), 28W(14pcs), 35W(11pcs), 24W(16pcs), 39W(10pcs), 54W(7pcs)

Accessories

a Connecting cables

DLPTC/T	DLPTC1/T	DLPTC2/T	DLPTC4/T	DLPTC6/T
150mm(6inch)	300mm(1feet)	600mm(2feet)	1200mm(4feet)	1800mm(6feet)

b Direct connector : DLCPL/T

c Power cord

- DLPC230/T
- DLPC230/SM2/T (Straight type)

d Diffuser

SL8CV	SL14CV	SL21CV	SL28CV	SL35CV
8W	14W	21W	28W	35W

e Mounting Bracket

f Fluorescent lamps

- 2200K, 2700K, 3000K, 3500K, 4000K, 6500K, 8000K, Red, Green and Blue are available.

g On/Off switch : DLSB/T

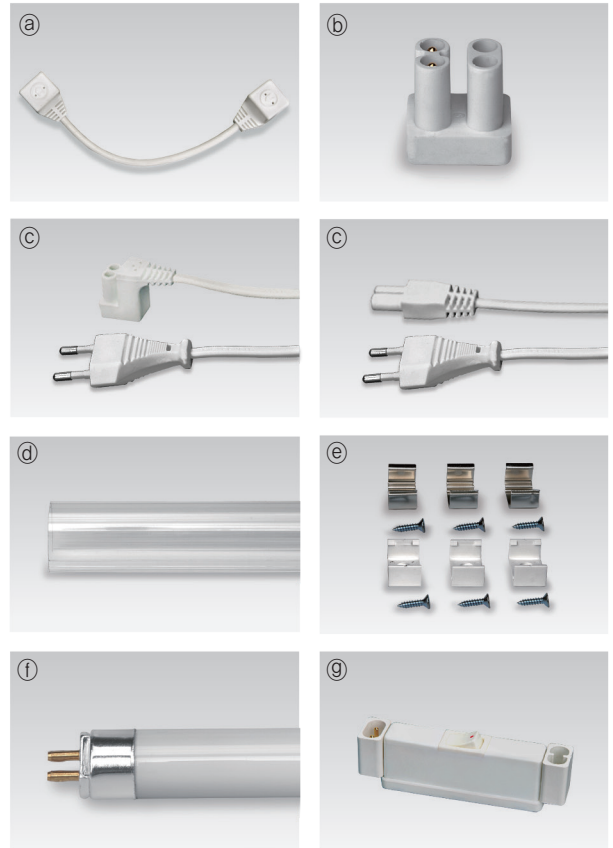

Model Name	LampPower (W)	lm	L (mm)	W (mm)	H (mm)	H (mm) with diffuser
SL8AB23NN/T	8	430	345	22.6	33	35.5
SL14AB23NN/T	14	1200	595	22.6	33	35.5
SL21CB23NN/T	21	1900	895	22.6	33	35.5
SL28CB23NN/T	28	2600	1195	22.6	33	35.5
SL35CB23NN/T	35	3300	1495	22.6	33	35.5
SL24AB23NN/T	24	1750	595	22.6	33	35.5
SL39CB23NN/T	39	3100	895	22.6	33	35.5
SL54CB23NN/T	54	4450	1195	22.6	33	35.5

